

**CITY OF NOME**  
P.O. Box 281  
Nome, Alaska 99762  
907.443.6663  
www.nomealaska.org

## MOONLIGHT WELLS PERMIT

**Date of Issuance:** April 24, 2021

**Permittee:** Shawn Pomrenke  
Northwest Gold Diggers, LLC  
P.O. Box 629  
Nome, Alaska 99762

**Authorizing Resolution:** R-21-XX-XX

**Authorized Activity:** Placer Mining

---

This permit authorizes only the named permittee, Shawn Pomrenke, dba Northwest Gold Diggers, LLC, to operate a placer mine within the Moonlight Wells Protection Area on the following properties:

- MS 707 IXL Placer Claim
- MS 1212 Bench Claim No. 4 Placer

This permit is valid only for 2021.

The State of Alaska APMA # 2812 and associated permits issued by the State of Alaska for the APMA are adopted as part of this permit.

All placer mining and associated activities shall be in accordance with the terms and conditions set forth in this permit.

For the area proposed for placer mining, identified above, the following best management practices (BMPs) should be used:

**1. Fuel handling and storage: (severe to high risk activity)**

The owner has indicated that fuel for equipment will be hauled from outside the Moonlight Wells Protection Area (MWPA) in a 2,500-gallon fuel truck. A 500-gallon, double walled, fuel tank is proposed for on-site storage of fuels. Provide for a spill kit on the delivery truck for any spills during fuel transfers. All fueling performed from the 500-gallon tank to the excavator or wash plant will be continuously observed during the fueling operation, and the tank will be securely locked when not in use.

All equipment working within the permitted area shall have absorbent materials on it to be used in the event of a petroleum spill.

**2. Hazardous materials: (severe to high risk activity)**

Lubricants, solvents, and oils should be secured and properly stored at all times.

All waste oils and used filters should be carefully collected and disposed of at an approved waste oil receiving facility.

No hazardous, ignitable, corrosive, reactive or EP toxic materials shall be used or stored within the permitted properties.

A service truck will be used for daily servicing of equipment, but will be stored outside the MWPA when not in use.

**3. Trash handling on-site: (high risk activity)**

All trash generated at the mining site should be collected and disposed of at the municipal landfill. No trash or garbage shall be buried on site.

**4. Process water pumping and holding pond operations: (medium risk activity)**

An existing pond in M.S. 707 No. 3 Above Discovery on Little Creek Placer will be used for process water extraction. The pond is estimated to contain about 3 million-gallons and will be pumped 10 to 12 hours/day – estimated in the 30,000 to 40,000 gal./day range. The process water will flow through a settling pond on M.S. 1193 No. 5 Below on Cooper Gulch Placer and is intended to be returned to the extraction pond on M.S. 707.

Any increased withdrawal rates, resulting in a daily drawdown of the pond exceeding 12-inches, should be brought to the City's attention for review and additional monitoring of the static levels of the Moonlight Wells.

The holding pond, which is located just outside the Protected Area boundary, was created as a mining cut in 2018 and has no obvious signs of breakouts or breaching.

**5. Depth of cuts for ore-bearing gravel extraction:**

Excavation to depths of 35-45 feet are anticipated. If groundwater seeps or standing water is encountered, excavation will cease, and the area will be backfilled with a minimum of 2 feet of low permeability (high fines content) soils to cover the groundwater.

**6. Pit privies in the Protected Area: (high risk activity)**

There is no pit privy at the mining site. A "Porta Potty" may be used within the MWPA if needed.

**7. Restoration details: (moderate risk activity)**

The referenced DNR permitting process also covers restoration activities. The periodic inspections by the City Engineer or City representative should include a review of the restoration work and identification of any remedial work that is needed within the Protected Area. The BMP for this activity is compliance with DNR guidelines, and a rational approach to restoring lines and grades to disturbed lands; along with restoring natural drainage patterns to minimize erosion and down gradient silt transport.

Further conditions of the permit are:

- A. Any modifications to this permit must be submitted to the City Engineer for review and approval.
- B. The permittee shall allow the City Manager or his representative access to the permitted sites at reasonable times to conduct scheduled or unscheduled inspections or tests to determine compliance with the permit, City laws, and regulations.
- C. The permittee hereby agrees to hold the City of Nome harmless, and indemnify the City of Nome, from and against any and all loss damages to the Moonlight Wells municipal water supply caused by or resulting from the acts or omissions of the permittee, its agents, employees, subcontractors, suppliers or assigns.
- D. The permittee hereby agrees to provide proof of insurance in the form of an ACCORD certificate to the City of Nome, and, if requested by Nome, a copy of one or more policies referenced in the certificate.
- E. Failure to comply with conditions of the permit shall be grounds for immediate suspension of the permit by the City until corrective action has been taken and approved by the City. Non-compliance reports and a report of corrective action

shall be transmitted to the City Engineer for review. The City Engineer, upon notice from the City, shall review compliance reports and may recommend termination of the permit for repeated non-compliance with permit conditions.

F. The permit is effective upon approval of the Nome City Council, by Resolution and only when the City Engineer has issued a written notice to proceed.

The permittee, by signing the permit shall agree to the conditions contained therein.

DATED this \_\_\_\_\_ day of \_\_\_\_\_, 2021.

CITY OF NOME, ALASKA

By: \_\_\_\_\_  
City Manager

ATTEST:

\_\_\_\_\_  
Bryant Hammond, City Clerk

RECEIVED and ACKNOWLEDGED this \_\_\_\_\_  
Day of \_\_\_\_\_, 2021.

Northwest Gold Diggers, LLC

By: \_\_\_\_\_  
Permit applicant: Shawn Pomrenke

Attachments:

Moonlight Wells Permit Application  
Pomrenke – Plan of Operations 2021-2022 Season dated April 22, 2021  
State of Alaska APMA # 2812



# Moonlight Wells Permit Application

Please answer all questions. The information provided on this application form will help determine whether your development activity poses a significant risk to the Moonlight Springs aquifer that is the City of Nome's public water system water source, and whether a development permit is required.

Development activity includes, but is not limited to excavation or alteration of terrain using mechanized equipment; building structures, storage or use of possible aquifer contaminants such as fuel or chemicals; well drilling; development of septic/wastewater systems; mining and other commercial or residential development activities within the Moonlight Wells Protection Area (see attached map).

Development does not include non-mechanized terrain disturbing activities, hiking, camping, berry picking; use of recreational off-road vehicles such as snow machines or 4-wheelers.

If the answer to any of the following questions is yes, your proposed activity is subject to the permitting requirements of the Nome Code of Ordinances Chapter 10.20 (O-06-10-02).

If you have questions regarding the information requested, or whether your activity is classified as a development activity, please contact City Hall at 907.443.6663.

## APPLICANT INFORMATION

<p>1. <u>Northwest Gold Diggers LLC</u></p> <p>Name of Applicant <u>P.O. #629</u></p> <p>Address <u>Nome AK</u> <u>99762</u></p> <p>City/State <u>(907) 304-1199</u> Zip Code</p> <p>Daytime Phone <u>N/A</u></p> <p>Fax Number <u>N/A</u></p> <p>E-mail Address <u>smpomrenke@yahoo.com</u></p>	<p>2. <u>Shawn Pomrenke</u></p> <p>Agent (or responsible party if other than applicant) <u>P.O. #2005</u></p> <p>Address <u>Nome AK</u> <u>99762</u></p> <p>City/State <u>(907) 304-1199</u> Zip Code</p> <p>Daytime Phone <u>N/A</u></p> <p>Fax Number <u>N/A</u></p> <p>E-mail Address <u>smpomrenke@yahoo.com</u></p>
--	--

## DEVELOPMENT ACTIVITY INFORMATION

1. Do you currently have any State, federal or local approvals or permits for your development activity? Yes  No

Note: Approval means any form of authorization. If "yes," please list below:

Approval Type	Approval #	Issuance Date	Expiration Date
<u>AMP multi year</u>	<u>2812</u>	<u>1-7-18</u>	<u>1-7-2022</u>
_____	_____	_____	_____
_____	_____	_____	_____







**Wastewater**

- |  | Yes                      | No                                  |
|--|--------------------------|-------------------------------------|
| 1. Will a discharge of wastewater from industrial or commercial operations occur? .....                                      | <input type="checkbox"/> | <input checked="" type="checkbox"/> |
| 2. Will the discharge be connected to an already approved sewer system?.....   | <input type="checkbox"/> | <input type="checkbox"/>            |
| 3. Do you intend to construct, install, modify, or use any part of a wastewater (sewage or greywater) disposal system? ..... | <input type="checkbox"/> | <input type="checkbox"/>            |

If you answered yes to 1-3, answer the following:

- |  |                                     |                                     |
|--|-------------------------------------|-------------------------------------|
| 1) What is the distance from the bottom of the system to the top of the subsurface water table?        | _____                               |                                     |
| 2) How far is any part of the wastewater disposal system from the nearest surface water?               | _____                               |                                     |
| 3) Is there a water well or exploratory boreholes within 100 feet of the disposal system?              | _____                               |                                     |
| 3) Is the surrounding area inundated with water at any time of the year? .....                         | <input type="checkbox"/>            | <input type="checkbox"/>            |
| 4. Do you intend to dewater an excavation? .....   | <input type="checkbox"/>            | <input checked="" type="checkbox"/> |
| 5. Do you intend to dispose of water from piping, containers, tanks, or hydrostatic testing? .....     | <input type="checkbox"/>            | <input checked="" type="checkbox"/> |
| 6. Has the wastewater disposal been reviewed and approved by ADEC?.....                                | <input type="checkbox"/>            | <input checked="" type="checkbox"/> |
| 7. Does your development activity qualify for an ADEC general permit for wastewater?.....              | <input type="checkbox"/>            | <input checked="" type="checkbox"/> |
| 8. Do you intend to engage in an activity that will disturb one acre or more of land? .....            | <input checked="" type="checkbox"/> | <input type="checkbox"/>            |
| 9. If you answered yes to 8, have you complied with stormwater pollution prevention requirements?..... | <input type="checkbox"/>            | <input checked="" type="checkbox"/> |

**Solid Waste Disposal**

- |  | Yes                                 | No                                  |
|--|-------------------------------------|-------------------------------------|
| 1. a) Will your development activity result in the construction, operation of a facility for the disposal of solid waste? .....  | <input type="checkbox"/>            | <input checked="" type="checkbox"/> |
| <i>(Note: Solid waste means drilling wastes, household garbage, refuse, sludge, construction or demolition wastes, industrial solid waste, asbestos, and other discarded, abandoned, or unwanted solid or semi-solid material, whether or not subject to decomposition, originating from any source. Disposal means placement of solid waste on land.)</i>                         |                                     |                                     |
| b) Will your development activity result in the treatment of solid waste at the site? .....  | <input type="checkbox"/>            | <input checked="" type="checkbox"/> |
| <i>(Examples of treatment methods include, but are not limited to: incineration, open burning, baling, and composting.)</i>  |                                     |                                     |
| c) Will your development activity result in the storage or transfer of solid waste at the site?.....   | <input type="checkbox"/>            | <input checked="" type="checkbox"/> |
| d) Will the development activity result in the storage of materials for reuse, recycling, or resource recovery? .....  | <input type="checkbox"/>            | <input checked="" type="checkbox"/> |
| e) Will any sewage solids or biosolids be disposed of or land-applied to the site? .....   | <input type="checkbox"/>            | <input checked="" type="checkbox"/> |
| <i>(Sewage solids include wastes that have been removed from a wastewater treatment plant system, such as a septic tank, lagoon dredge, or wastewater treatment sludge that contain no free liquids. Biosolids are the solid, semi-solid, or liquid residues produced during the treatment of domestic sewage in a treatment works which are land applied for beneficial use.)</i> |                                     |                                     |
| f) Are your solid wastes tailings or waste rock from a mining operation?.....  | <input checked="" type="checkbox"/> | <input type="checkbox"/>            |
| g) Will you be disposing of, or stockpiling contaminated soil? .....   | <input type="checkbox"/>            | <input checked="" type="checkbox"/> |



Yes No

**Land Application of Chemicals**

- 1. Will your development activity require the application of oil, pesticides, and/or any other broadcast chemicals, including fertilizers, dust palliatives? .....  Yes  No

**Fuel and Hazardous Substance Storage**

- 1. a) Will your development activity involve fuel or hazardous chemical storage in aboveground or underground storage tanks, buildings or yards? ..... SEE ATTACHED LETTER  Yes  No
- b) If the answer to the above question is yes, what is substance being stored and quantity?  
500gal double walled tank
- c) What spill containment and leak detection systems are proposed for storage facilities  
double walled tank
- d) Have you provided the fire department or emergency response organization with information about your storage facilities and substances? I will once we start .....  Yes  No
- 2. Will your activity involve transportation or fuel or hazardous chemicals, or mobile storage (tank trucks) and dispensing of fuel? ..... SEE ATTACHED LETTER  Yes  No

**Excavation and Fill**

- 1. Do you plan to excavate/remove materials? .....  Yes  No
- 2. Do you plan to stockpile or place fill? .....  Yes  No
- 3. Do you plan to develop a quarry or material site? .....  Yes  No

**Wells and Drilling**

- 1. Are you planning to drill a water well? .....  Yes  No
- 2. Are you planning to drill exploratory boreholes to obtain samples or other geologic information? .....  Yes  No
- 3. Are you planning to drill an injection well? .....  Yes  No

**Agriculture/Livestock**

- 1. Will you be establishing an animal, livestock or dog lot operation? .....  Yes  No
- 2. Will you be engaged in commercial agriculture or greenhouse operations? .....  Yes  No

**Water Rights**

- 1. If you plan to use water from a drilled well, have you obtained water rights from the State? .....  Yes  No

**Permits**

Provide a list of state and federal permits or other environmental regulatory authorizations you have already obtained for your activity or anticipate obtaining. Include general permits, notices of intent and plans that are required. List codes and regulations that may not necessarily result in a permit, as well. This listing may be limited to only those requirements that are intended to prevent pollution of groundwater, surface water and land/soils.

AGENCY	AUTHORIZATION TYPE or REGULATORY REQUIREMENT	DATE RECEIVED or EXPECT TO RECEIVE or COMPLY
DNR	multigear Apma	1-17-2018



April 22, 2021

NORTHWEST GOLD DIGGERS LLC

P.O. BOX 2005

Nome, AK 99762

Plan of operations 2021 2022 season

development and activity description

Activity includes stripping overburden off of designated pits and removal of pay gravels to a approximate depth of 35 to 45 feet. The pay gravels lie on top of a ancient beach consisting of fine gravel and sand. There is no need to disturb the bottom beach material as there is no gold values in it. After observing last years pit witch is below this years pit the water table is well below the new cuts. We will not be filling in the cuts from previous years and will be sloping the edges and conturing for erosion and seeding. Mining activity will not exceed past M.S. 707 or M.S. 1212.

Wash plant is still in its original location on MS707 ok claim. The wash plant will be moved to south end of MS1193 No 4 Below Cooper claim around July 1st 2021 if there is sufficient amounts of pay dirt found in new cuts. Mining commences at or around May 15th and ends around November 1st of every year. All make up water will come from outside the Moonlight springs protected area if the wash plant is moved. If the wash plant is moved fuel will be stored in a double walled 500gal tank with a 120volt electric pump when refueling is done it will be maned at all times. This tank will be refueled with a 2500gal fuel truck that will not be stored inside the moonlight springs protected area. There will be spill response equipment on site including absorbent pads, oil boom, Particulate oil absorbent (floor dry). The equipment that will be serviced inside the protected area will be refueled and serviced with a service truck equipped with a 700gal fuel tank and oil and grease and will be maned at all times. When servicing is finished the service truck will be stored outside the protected area. Any major repairs to equipment when possible will be done outside the protected area. Any spills or leaks in excess quantities that are reportable under CWA section 311 would immediately be reported tp the city and state of Alaska DEC. IF in the event of a spill or leak we would take immediate action to eliminate and contain. Second we would contact City of Nome and DEC. Third we would collect and remove all contaminated soils and debris from protection area to a designated remediation site outside the protected area.

Preventative maintenance and spill response equipment

1. If ground water is encountered excavation will stop and area will be back filled with a minimum of 2feet of low permeability (high fines content) soils to cover ground water

2. We have a spill response van and adequate equipment to respond to a spill in the event of one
3. Any oil leaks or seepage on all equipment would be repaired immediately
4. The most likely spill would be from a ruptured hose on equipment in the protected area and it is mandatory for all personal to do a daily inspection of equipment and equipment hoses. Any and all hoses that rare found to be damaged or worn will be replaced immediately.
5. The only fuel that will be stored inside the protective area will be stored in a 500gal double walled tank that would be used to fuel wash plant and excavator when fueling is being done it will be maned at all times. If the wash plant is relocated.
6. All equipment will be removed from the protected area at the end of the season except for the wash plant witch will be drained of all fuel and oil.
7. Wastewater, Questions 7 8and 9 relate to state of Alaska stormwater pollution prevention plan. (SWPPP). After contacting DEC Nicholes Dallman this is not required from the state for this project.
8. We will keep equipment in the protection area to a minimum for the operation.
9. Oil and fuel containment has always been a top priority to us and does not mix with gold mining and gold recovery.
10. I am a long time resident of Nome with a home that uses the city water source and take the protection of it very seriously. Its my belief that this mining project will not adversely affect the moonlight springs water shed and look forward to working with the city on this operation.

Sincerely yours,

Shawn and Steve Pomrenke

Northwest Golddiggers LLC





2021 PLAN OF OPERATIONS

PROPOSED MINING CUT FILL 2021 CEMEN  
 250' WIDE AND 100' LONG 30' DEEP

MOONLIGHT WELLS  
 PROTECTION AREA



2021

WASH PLANT  
 SLUDGE POND

SETTLING POND 1  
 SAMS CLAY 193

WATER CUT LINE  
 9 X 6 TO 200'

MOONLIGHT WELLS

WEDGE FRACTION

PEARL BEN

PEARL BEN

PEARL BEN

PEARL BEN

PEARL BEN

PEARL BEN

PEARL BEN

PEARL BEN

PEARL BEN

PEARL BEN

PEARL BEN

PEARL BEN

PEARL BEN

PEARL BEN

PEARL BEN

PEARL BEN

PEARL BEN

PEARL BEN

PEARL BEN

PEARL BEN

PEARL BEN

PEARL BEN

PEARL BEN

PEARL BEN

PEARL BEN



NEW CLAIMS BEING ADDED  
TO #2812

STATE OF ALASKA  
Application for Permits to Mine in Alaska (APMA)

Single Year  Multi-year - Start: 2017 Finish: 2022 APMA \_\_\_\_\_ (District/Year/Number)

What type activity are you planning to perform?		Surface estate of mineral properties:	
<input type="checkbox"/> Exploration/Reclamation	<input type="checkbox"/> Access Equipment	<input type="checkbox"/> State (General)	<input type="checkbox"/> State (Mental Health) (1)
<input checked="" type="checkbox"/> Mining/Reclamation	<input type="checkbox"/> Suction Dredge	<input checked="" type="checkbox"/> Private (Patented)	<input type="checkbox"/> Federal
<input type="checkbox"/> Hardrock Exploration/Reclamation	<input type="checkbox"/> Reclamation	<input type="checkbox"/> Private (Native Corp.)	<input type="checkbox"/> City or Borough

Check, as appropriate, and indicate permit number, if any of the following agencies have previously issued permits for these mineral properties:

DNR-Water TWUP/ADL/LAS No: \_\_\_\_\_  DEC- APDES Wastewater discharge permit #: \_\_\_\_\_ (2)

ADF&G - Habitat Permit No: \_FH-\_\_\_\_\_ Date expires \_\_\_\_\_

BLM - Notice \_\_\_\_\_ Authorization \_\_\_\_\_ Occupancy \_\_\_\_\_

USACE Permit No(s) for this APMA # POA- \_\_\_\_\_ POA - \_\_\_\_\_

Other State or Federal Permit No: MULTI-YEAR APPROVER RECLAMATION PLAN # 2812

Mineral Property Owners: (3) Company name and contact name if applicable	Lessee: (4) Company name and contact name if applicable	Operator: (5) Company name and contact name if applicable
<u>ALASKA GOLD COMPANY</u>		<u>NORTHWEST GOLD DIGGERS LLC</u>

Mailing Address for official correspondence: <u>4600 DE BARR RD SUITE 200</u> <u>ANCHORAGE AK 99508</u>	Mailing Address for official correspondence:	Mailing Address for official correspondence: <u>P.O. BOX 629</u> <u>NOME AK 99762</u>
---	--	---

Home phone# (winter): <u>1-907-563-3788</u>	Home phone# (winter):	Home phone# (winter): <u>1-907-443-5875</u>
--	-----------------------	--

Work phone# (winter): <u>1-907-563-3788</u>	Work phone# (winter):	Work phone# (winter): <u>1-320-630-7260</u>
--	-----------------------	--

Home phone# (summer): <u>1-907-563-3788</u>	Home phone# (summer):	Home phone# (summer): <u>1-907-443-5875</u>
--	-----------------------	--

Work phone# (summer): <u>1-907-563-3788</u>	Work phone# (summer):	Work phone# (summer): <u>1-320-630-7260</u>
--	-----------------------	--

Cell/Satellite: <u>N/A</u>	Cell/Satellite:	Cell/Satellite: <u>N/A</u>
----------------------------	-----------------	----------------------------

FAX: <u>1-907-563-2742</u>	FAX:	FAX: <u>N/A</u>
----------------------------	------	-----------------

E-mail:	E-mail:	E-mail: <u>CPOMRENKE.AK@MAIL.DOT.COM</u>
---------	---------	--

Winter contact effective dates fgnsfhnsf to <u>ALL YEAR</u>	Winter contact effective dates _____ to _____	Winter contact effective dates <u>11-1</u> to <u>5-1</u>
Summer contact effective dates <u>ALL YEAR</u> to <u>ALL YEAR</u>	Summer contact effective dates _____ to _____	Summer contact effective dates <u>5-1</u> to <u>11-1</u>

Project Name If Applicable: (6) <u>COOPER MINE</u>	# of Workers: (7)	Start-Up/Shut Down: (Month/Day) (8) <u>6-1</u> to <u>10-1</u>
---	-------------------	--

Mining District: (9) <u>NOME</u>	Applicable USGS Map: (10) <u>NOME C-1 B-1</u>	On What Stream Is This Activity? (11) <u>NO STREAM</u>
-------------------------------------	--	---

Legal Description of mineral properties to be worked and other projected related activities (MTRS): (12)

NO. 3 ABOVE DISCOVERY ON LITTLE PLACER CRK (707)  
NO 5 BELOW ON COOPER GULCH PLACER - (1193)  
(EXL PLACER 707) NO4 BELOW PLACER (1193)  
BENCH CLAIM NO. 4 PLACER (1212) OC ASSOCIATION PLACER (1371)  
SAID CLAIMS ARE SITUATED IN SECTIONS 11, 12, T. 115 R. 34W, KRM.



ACCESS OUTSIDE OF CLAIM BLOCK

(16)

Access across surface estates not owned by the State requires approval of the managing agency. It is the responsibility of the applicant to contact the owners of private property to obtain authorization for access.

A completed access map must be submitted with your application. Copies of USGS topographic maps at a scale of 1"=1 mile must clearly indicate the proposed access route from start to finish and include appropriate legal descriptions (township and range) on each map sheet. The quadrangle map name should also be indicated (Healy A-3, etc.). Paper size should be limited to 8 1/2" x 11". Do not tape maps together.

Access outside the claim block crosses what type of land(s)?  State (General)  State (Mental Health)  
 City/Borough  Federal  Private  Private (Patented)  Private (Native Corp. Land)

Does the proposed route of travel include use of RS 2477 access?  Yes  No. If the RS 2477 ROW has a State of Alaska RST number, please list \_\_\_\_\_.

If not, do you wish to nominate the route for RST assertion?  Yes  No.

Access is:  Existing  To be constructed off of claim block  Both

Indicate Type(s) of existing access:

- All Season Road: May be an improved dirt road intended to be used during all seasons of the year without causing long term damage to the road.
- Summer Cross Country Travel off of claim block that is not generally allowed
- Existing airstrip  Airstrip to be constructed off of claim block
- River
- Winter Cross Country Travel that is not generally allowed - Travel is not authorized if damage could occur.

Will water be needed to construct ramps/ ice bridges?  Yes  No.

If Yes, estimated quantity of water will be used NA gallons/day

List all equipment and vehicles being transported:

NO 2 DIESEL 2500 GALLONS

Are you transporting fuel?  Yes  No If "yes", indicate type and amount:

MOTOR AND HYDRAULIC OIL 55 GALLON DRUMS

Are you transporting other petroleum products?  Yes  No If "yes", indicate type and amount:

YES  
~~YES~~ - MOTOR OILS IN 55 GALLON DRUMS DIESEL IN FUEL TRUCK

Are petroleum products contained? (i.e., drums, bladders, steel tanks, etc.) Indicate size of containers:

IN 55 GALLON DRUMS AND 2500 GALLON FUEL TRUCK

How are petroleum products being transported? (i.e., skid-mounted tank; trailer; 55 gallon drums on skid; etc.)

NO CROSS COUNTRY TRAVEL

Indicate proposed dates for each period of cross country travel:



**PLACER MINING METHOD**

(17)

Mechanical Placer Mining (e.g., terrestrial open-cut operations with dozer or excavator)

Estimated cubic yards processed annually: 50,000

Suction dredge       Mechanical dredge (e.g., excavator or clam-shell)  
List all suction and mechanical dredges. If information is not applicable, write "N/A." Attach extra sheet if necessary.

	Dredge 1		Dredge 2		Dredge 3	
Vessel ID (Name or Number)	N/A		N/A		N/A	
Vessel Dimensions						
Suction Dredge Intake Nozzle Diameter / Pump Size	Inches:	HP:	Inches:	HP:	Inches:	HP:
Mechanical Dredge Bucket Volume	Cubic Yards:		Cubic Yards:		Cubic Yards:	
Processing Rate	Yds. <sup>3</sup> /Hr.:		Yds. <sup>3</sup> /Hr.:		Yds. <sup>3</sup> /Hr.:	
Wastewater Discharge Rate	GPM:		GPM:		GPM:	
Maximum Water Depth	Feet:		Feet:		Feet:	
Average Daily Operating Hours						
Operation on Sea Ice (Yes/No)	Yes <input type="checkbox"/> / No <input type="checkbox"/>		Yes <input type="checkbox"/> / No <input type="checkbox"/>		Yes <input type="checkbox"/> / No <input type="checkbox"/>	

Location:  Offshore / Salt Water     Stream     Pond connected to stream  
 Pond isolated from stream     Mine cut isolated from stream  
Additional Dredges (include all information above):

List any APMA's that include additional dredges:

**EXPLOSIVES**

(18)

Will explosives be used?  Yes     No    If "Yes", Indicate: Type: \_\_\_\_\_ Amount: \_\_\_\_\_

**FUEL AT MINE SITE**

(19)

Total Volume of Fuel Stored in 55 Gallon or Larger Containers: 2500 IN FUEL TRK Gallons

Indicate Distance Stored From Flowing Waters: 400 Feet (Minimum distance from naturally occurring water bodies required by DNR is 100 feet).

Are fuel containment berms around storage containers?  Yes     No    Is berm area lined?  Yes     No

**STRUCTURES / FACILITIES**

(20)

Request use of existing facilities (Indicate number and size of each):

NO CAMP NEEDED

Area of Camp: Length N/A Feet    Width \_\_\_\_\_ Feet

Frame \_\_\_\_\_     Trailer \_\_\_\_\_     Tent/Tent Frame \_\_\_\_\_

Request authorization to place temporary structures (Indicate number and size of each):

Area of Camp: Length \_\_\_\_\_ Feet    Width \_\_\_\_\_ Feet

Frame \_\_\_\_\_     Trailer \_\_\_\_\_     Tent/Tent Frame \_\_\_\_\_

Camp authorization not needed

If camp is on private land, provide camp name: N/A and camp location: \_\_\_\_\_



### EXPLORATION TRENCHING

(21)

(Indicate locations on sketch sheet and/or topographic map)

Estimated number of trenches to be excavated: N/A

Average Size: Length: \_\_\_\_\_ Feet Width: \_\_\_\_\_ Feet Depth: \_\_\_\_\_ Feet

How long will trenches be open? \_\_\_\_\_

#### Trench Location and Mining Claim Information

Trench ID on Map	ADL/BLM/USMS NUMBER	NAD 83 Datum - Coordinates can be obtained using Alaska Mapper <a href="http://dnr.alaska.gov/MapAK/">http://dnr.alaska.gov/MapAK/</a>	
		Latitude	Longitude (approximate)
<u>N/A</u>			

If more than 5 trenches, please provide data in tabular format (<http://dnr.alaska.gov/mlw/forms/?tab=mining>).

### EXPLORATION DRILLING

(22)

(Indicate locations on sketch sheet and/or topographic map)

Number of Holes To Be Drilled: N/A Type of Drill Used: \_\_\_\_\_

Estimated Maximum Depth: \_\_\_\_\_ Feet Diameter of Holes: \_\_\_\_\_ Inches

Will water be used?  Yes  No

How Will Drill Holes Be Plugged Upon Completion? \_\_\_\_\_

#### Placer Drill Hole Location and Mining Claim Information

Drill Hole ID on Map	ADL/BLM/USMS NUMBER	NAD 83 Datum - Coordinates can be obtained using Alaska Mapper. <a href="http://dnr.alaska.gov/MapAK/">http://dnr.alaska.gov/MapAK/</a>	
		Latitude	Longitude (approximate)
	<u>N/A</u>		

If more than 5 holes, please provide data in tabular format (<http://dnr.alaska.gov/mlw/forms/?tab=mining>).



AMMENDED - ADDING 2 MORE SETTLING ~~2~~ POND.

WATER USE AUTHORIZATIONS

(23)

Water usage (including 100% recycle systems) may require authorization by either Temporary Water Use Authorization or a Water Right Permit or Certificate. Information provided below will be used to determine the quantity of water that you may be authorized to use for your mining operation. When estimating water quantities, please estimate withdrawal amounts typical of a dry summer and provide the maximum quantity that you may withdraw from a particular source (e.g. stream, pond, groundwater, etc.) in a season.

A Temporary Water Use Authorization application may be initiated from this APMA application unless a Water Right is requested. Please contact the ADNR, Water Resources Section at telephone number (907) 451-2790 if interested in a Water Right or for more information.

**A. START-UP WATER AND MAKE-UP WATER:**

Is water withdrawn from any lake, stream, creek, river, etc. (does not include recycling/settling ponds)?  Yes  No

What is the name(s) of the lake, stream, creek, river, etc.? EXISTING POND NO NAME

What are the months of water use needed (for example May 1<sup>st</sup> through October 31<sup>st</sup>)? 6-1- to 10-15

**Start-up water:** Is water required at the start of the season to fill your recycle/settling pond system?

Yes (if **YES**, complete information below).  No

- Source:  Groundwater gain from cut / Seepage infiltration from stream  
 Diversion ditch from stream. Number of days diverting from stream for start-up water: \_\_\_\_\_  
Water intake rate: \_\_\_\_\_ gpm \_\_\_\_\_ hrs/day  
 Pump from stream. Number of days pumping from stream for start-up water: \_\_\_\_\_  
Number of water pumps for start-up water: \_\_\_\_\_ Water intake rate (list for each pump): \_\_\_\_\_ gpm  
\_\_\_\_\_ hrs/day

**Make-up water:** Is water required to maintain water level in your recycle/settling pond system?

Yes (if **YES**, complete information below).  No

- Source:  Groundwater gain from cut / Seepage infiltration from stream  
 Ditch from stream. Number of days diverting from stream for make-up water: \_\_\_\_\_  
Water intake rate: \_\_\_\_\_ gpm \_\_\_\_\_ hrs/day  
 Pump from stream. Number of days pumping from stream for make-up water: \_\_\_\_\_  
Number of water pumps for make-up: \_\_\_\_\_ Water intake rate (list for each pump): \_\_\_\_\_ gpm  
\_\_\_\_\_ hrs/day Pump intake size: \_\_\_\_\_ inches

**B. RECYCLE/SETTLING POND SYSTEM.**

Beaver ponds or other natural water features will not be permitted for use as settling ponds.

Is a pre-settling pond used?:  Yes  No Is recycle used?:  Yes  No

How many ponds are used in the recycle system? 4

Recycle pond is pond # 4 Settling pond is pond # 1, 2, 3



WASTEWATER DISCHARGE PERMIT APPLICATION

(25)

All mechanical placer mine, suction dredge, and mechanical dredge operations that discharge to a water of the U.S. require an Alaska Pollutant Discharge Elimination System (APDES) permit from DEC.

Do you want this APMA to act as an application or renewal for any of the following APDES general permits (GPs):

- Mechanical Placer Miners GP\* (open-cut terrestrial operations): [X] Yes [ ] No
Small-Size Suction Dredge GP (nozzle diameter of 6" or less): [ ] Yes [ ] No
Medium-Size Suction Dredge GP (nozzle diameter greater than 6" to 10"): [ ] Yes [ ] No
Norton Sound Large Dredge GP (nozzle diameter greater than 10" or mechanical dredge): [ ] Yes [ ] No

Waterbody the discharge flows directly into, or would potentially flow: NO DISCHARGE

Approximate coordinates of mine site:

Latitude: Longitude:
Source (e.g., DNR - Alaska Mapper): Datum:

\*Mechanical placer operations that do not elect coverage under the Mechanical Placer Miners GP may be required to obtain coverage under the Multi-Sector General Permit for Storm Water. Contact DEC for additional information.

Optional\* - Mixing Zone Request for Mechanical Placer Mine Operations

Do you wish to apply for a mixing zone and modified turbidity limit from DEC? [ ] Yes [ ] No

If a mixing zone is requested, provide the following: N/A

Maximum Effluent Flow anticipated from your operation (GPM) [must be greater than zero (0)]
Distance to nearest downstream drinking water source; placer mine water intake; and placer mine water discharge

\*The fee for an authorized mixing zone is \$150 annually. A mixing zone authorizes an increase in the permit's turbidity limit based on available dilution from the surface water. Permittees without mixing zones must meet the water quality standard for turbidity at the point of discharge into the surface water.

Certification Statement - applicable only to information required for DEC authorizations (required for all DEC permit or mixing zone applicants)

I certify under penalty of law that this document and all attachments were prepared under my direction or supervision in accordance with a system designed to assure that qualified personnel properly gather and evaluate the information submitted. Based on my inquiry of the person or persons who manage the system, or those persons directly responsible for gathering the information, the information submitted is, to the best of my knowledge and belief, true, accurate, and complete. I am aware that there are significant penalties for submitting false information, including the possibility of fine and imprisonment for knowing violations.

Signature of Responsible Party: [Handwritten Signature]

Responsible Party Name (First Last, Position) - Printed: STEVE PARENKE OWNER

Business Name (if applicable) - Printed: NORTHWEST GOLD DIGGERS LLC



AMMENDED 2017-2022

WETLAND JURISDICTIONAL DETERMINATION

(26)

A Wetland Jurisdictional Determination (Wetland JD) determines if a USACE "404" permit is required. A JD is required every 5 years, or, when a new area is impacted. Certain information is required. Please submit Wetland JD information with brand new APMA's and renewed Multi-Year APMA's.

1. A wetland jurisdiction is required under Section 404. The Corps will conduct an offsite Wetland JD when you provide a photo of your operation (a.) and answer a few other questions (b.)

a. Photograph of your operation, with outline showing all activity and facility locations for the next five years. Photos must be clear, sharp, and reproducible. Sources of photos include (Please check)

Aerial photos from your land manager; from a website or other sources (Alaska Mapper printouts are generally not acceptable.) Please outline your entire footprint on the photo.

Photos taken by you. On a map, mark locations of where you took photos. Please provide all of the following:

- vegetation on and around your operation
- soil profile (from a bucket or shovel cut), Include an object for scale.
- creek and riparian area (if within your plan of operation)
- photos taken from top of hill or other high location to get an aerial view
- general photos of your operation

b. Other Questions - Do you have: (check all that apply):

Vegetation:  black spruce  shrubs  tussocks  muskeg  Other  
Non-pay Overburden:  None  Gravel 12' feet  Organic material 4" feet

Hydrology - Do you have:

- ponds that have naturalized
- other areas with saturated soil, or standing water
- frozen ground (permafrost soils)

How much of your proposed operation area has been previously mined? 9 Acres  
What is the total size of your operation (including new areas)? 139 Acres  
How many acres of black spruce, muskeg, frozen ground, etc.? 0 Acres  
How many acres do you think are uplands? ALL Acres

2. Hire a wetland consultant to do a JD for you.

3. Operators working in uplands do not need a Corps permit. Uplands include areas such as old tailings or other well drained areas. As a service, Corps will supply an email stating that 'No Permit is Required' to operators who supply photos of their operations in uplands.

Your signature indicates acceptance of a Preliminary Jurisdictional Determination. (PJD) A PJD is standard for remote operations, however it is not appealable. You may at any time provide more information to clarify your PJD. Corps will do an Approved JD when your operation is in uplands or a consultant supplied JD is submitted.

Applicant or Agent: Steve Pomorenko [Signature] 7-27-2017  
Print Name Signature Date



**STREAM DIVERSION**

(27)

**A MAP OF COMPLETE STREAM DIVERSION IS REQUIRED:** Plan Map of Operation included in the APMA should show the entire length of the diversion (i.e. where the water is diverted from the natural stream channel to where it returns to the natural stream channel).

**Please note:** If you have a stream diversion structure; this structure may also qualify as a dam and be subject to the Alaska Department of Natural Resources Dam Safety Program per definitions provided in AS 46.17.900(3). Complete Section 24 (regarding a Dam) of this APMA. If you require further regulatory guidance regarding dams, please contact our Dam Safety and Construction Unit, Dam Safety Engineer at telephone number 907-269-8636 or for more information go to the Alaska Dam Safety Program website at: <http://dnr.alaska.gov/mlw/water/dams/index.cfm>

**Is stream diversion required?**  Yes (if **YES**, complete information below).  No

Existing (Date Constructed \_\_\_\_\_)  To Be Constructed (Date \_\_\_\_\_)

**If a diversion is required or pre-existing, please contact your local ADF&G, Division of Habitat for Fish Habitat Permitting information. To facilitate permit issuance, please provide the following information:**

Is Stream Diversion?  Permanent  Temporary \_\_\_\_\_ year(s) \_\_\_\_\_ months

Will diversion be reclaimed annually prior to freeze-up or be retained throughout the mine life?

Annually reclaimed/returned to natural stream  Maintained throughout mine life

Dimensions of existing stream in diversion area:

Length \_\_\_\_\_(ft) Top Width\_\_\_\_(ft) Bottom Width\_\_\_\_(ft) Depth\_\_\_\_(ft) Floodplain Width\_\_\_\_(ft)

Dimensions of proposed diversion:

Length \_\_\_\_\_(ft) Top Width\_\_\_\_(ft) Bottom Width\_\_\_\_(ft) Depth\_\_\_\_(ft) Floodplain Width\_\_\_\_(ft)

Substrate type in diversion area:  Bedrock  Boulder  Cobble  Gravel  Sand  Silt/Clay

Note: Diversion should approximate the existing stream in terms of meander bends, length, depth, stream width, and floodplain width.

**(Please provide plan and profile diagrams of diversion in Section 28, PLAN MAP OF OPERATION)**





THE STATE  
*of* **ALASKA**

DIVISION *of* MINING,  
LAND *and* WATER

**MULTI-YEAR 2018-2022**

**APPROVED RECLAMATION PLAN**

**APPROVAL # 2812**

The Alaska Department of Natural Resources, Division of Mining, Land, & Water, in accordance with Alaska Statute 27.19 (Reclamation Act), does hereby grant an Approved Reclamation Plan to:

**ALASKA GOLD COMPANY**  
4600 DEBARR RD SUITE 200  
ANCHORAGE AK 99508

**NORTHWEST GOLD DIGGER LLC**  
P.O. BOX 629  
NOME AK 99762

This approval is for reclamation activity described in Application for Permits to Mine in Alaska # 2812.

**This operation has been bonded through the State Reclamation Bond Pool, under bond APMA #2812, for a proposed disturbance of 14 Acres, for the 2018 mining season.** The refundable portion of the bond pool deposit may be returned after reclamation is completed and approved by the Division of Mining, Land & Water.

In accordance with AS 27.19.050(c), you are required to file an Annual Reclamation Statement to serve as an annual report by December 31<sup>st</sup> each year this permit application is in effect, including photographs or video tape of the completed reclamation work. When submitting photography for approval, please photograph reclamation work prior to snowfall. Failure to submit this is a violation.

Effective dates of this approval shall be 1/17/2018 through 12/31/2022.

Changes to the intended Reclamation Plan described in Application for Permits to Mine in Alaska #2812 shall be submitted to this office in writing and approved in advance before such work can begin.

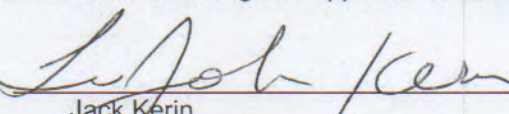
Approved:   
Jack Kerin  
Permitting/Field Operations

Date: 1/17/18



**NOTICE OF OPERATOR AUTHORIZATION -- STATE MINERAL LOCATIONS**

All operators or lease holders submitting APMA's for operations on State mineral locations must submit a "Notice of Authorization" from the owner of record. This notice of authorization must name the operator and leaseholder (if different), the claims(s) by Name and ADL number(s), and the time frame (beginning and ending dates) for which the authorization remains in force. The Division of Mining, Land & Water will not issue any mining permits until we receive this Notice of Authorization. **Please include it with your APMA.**

**OPERATOR AUTHORIZATION**

I, Harry W. Pederson <sup>for AGC, LLC</sup> OWNER of state claim(s):

Claim Name	ADL Number	Claim Name	ADL Number	Claim Name	ADL Number
<u>See attached Exhibits A &amp; B</u>					

(Attach additional sheet if necessary)

Have authorized Steve Pomrenke DBA NORTHWEST GOLD DIGGERS LLC

Address of Operator P.O. Box 629 Nome AK 99762

to operate on these claims from 8/1/2017 to 11/1/2022

Owner's Signature [Signature] <sup>VP Nome OPS.</sup> Date 7/26/17

**NOTARY**

Subscribed and sworn to before me this 26<sup>th</sup> day of July, 2017.

For (owner)

(Signature of Notary) [Signature]

My commission expires: 4/16/2020

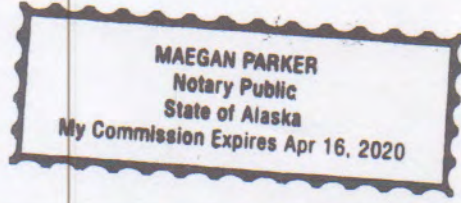

OR (If the LESSEE and OPERATOR are not the same, both sections must be completed)

I, NW GOLD DIGGERS LLC <sup>patented claims</sup> LESSEE of state claim(s):

Claim Name	ADL Number	Claim Name	ADL Number	Claim Name	ADL Number
<u>SEE ATTACHED EXHIBITS A+B</u>					

(Attach additional sheet if necessary)

have authorized Steve Pomrenke DBA NORTHWEST GOLD DIGGERS LLC to operate on these claims from 8/1/2017 to 11/1/2022

Lessee's Signature [Signature] Date 7-26-2017

Lessee's Address P.O. Box 629 Nome AK 99762

**NOTARY:**

Subscribed and sworn to before me this 26<sup>th</sup> day of July, 2017.

For (Lessee)

(Signature of Notary) [Signature]

My commission expires: 4/16/2020

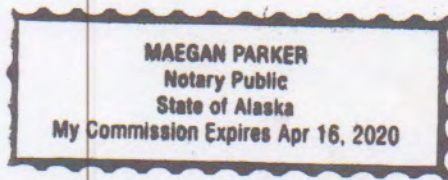



EXHIBIT A

Claims

<u>Name of Claim</u>	<u>U.S. Mineral Survey</u>	<u>Patent</u>	<u>Acreage</u>
1. No. 3 Above Discovery On Little Cr. Placer	707	yes	17.13
2. No. 5 Below On Cooper Gulch Placer	1193	yes	13.00
3 MS 707 NO & ABOVE			<del>30.13</del> 17.13

Said claims are situated in Sections: 11, 12, T.11S, R.34W, K.R.M.



EXHIBIT B  
Claims

<u>Name of Claim</u>	<u>U.S. Mineral Survey</u>	<u>Patent</u>	<u>Acreage</u>
1. I.X.L Placer Claim	707	yes	14.88
2. No. 4 Below Placer	1193	yes	16.00
3. Bench Claim No. 4 Placer	1212	yes	7.29
4. O.C. Association Placer	1371	yes	36.46
			74.63

Said claims are situated in Sections: 11, 12, T.11S, R.34W, K.R.M.



Figure 1. Project Location Map  
Northwest Gold Diggers Project  
ACCESS MAP  
CLAIM MAP

CLARK CREEK RD  
CLAIMS TO BE MINED  
MINE SITE

USGS Nome B-1, C-1 Quadrangles  
T.11 S., R.33 W. SECTIONS 11, 12  
Kateel River Meridian

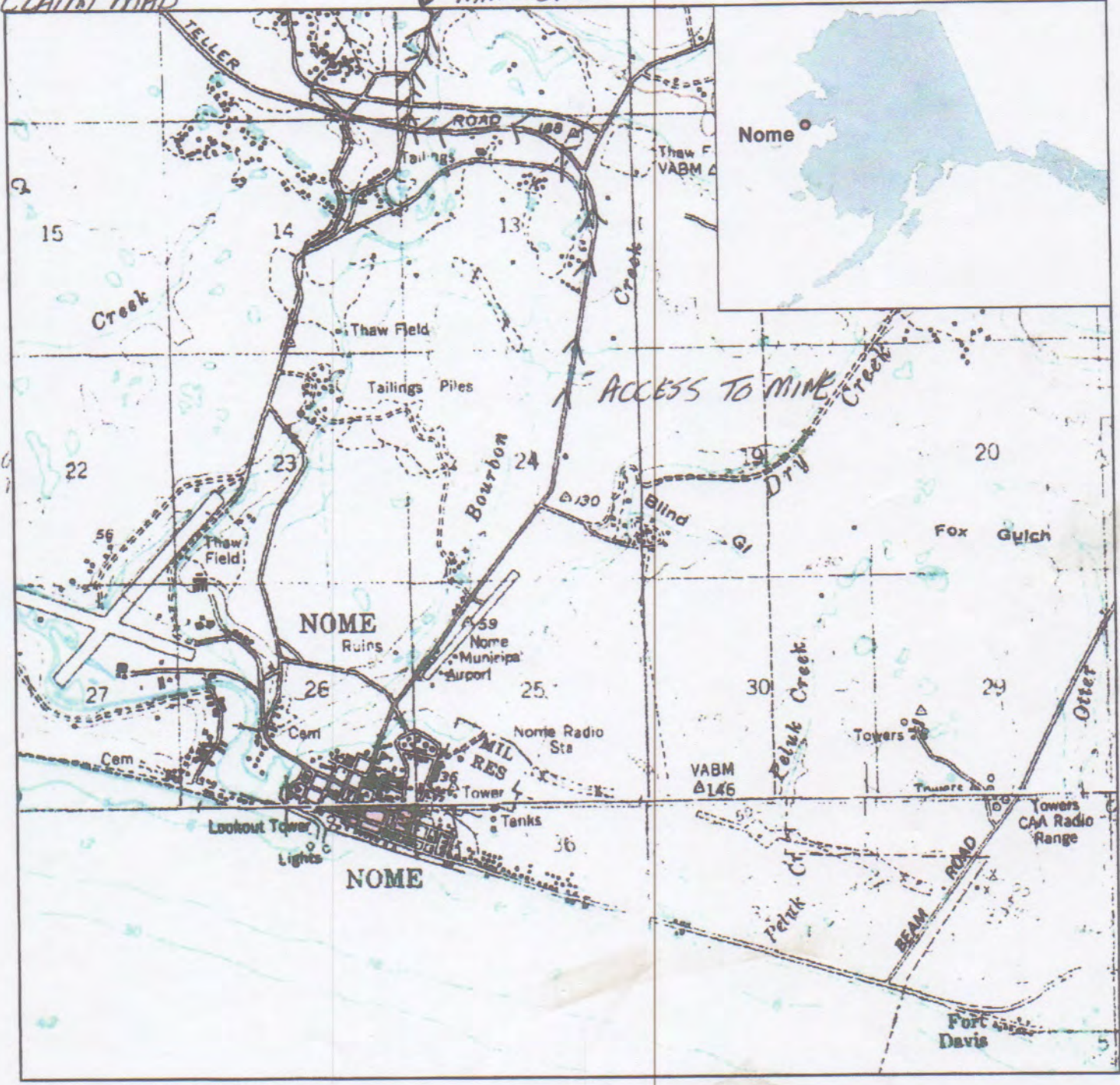

**Patented Claims**

 MS 2318

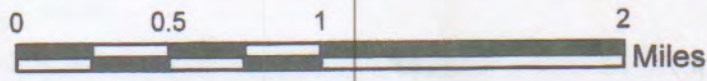



MINE PLAN NARRATIVE FOR CONTINUATION OF WORTHWEST GOLD DIGGER'S COOPER GULCH MINING PROJECT.

ADDING CLAIMS FOR CONTINUATION OF PROJECT

MS 707 ABOVE	707
MS 705 BELOW	1193
R34W, KRM I-XL PLACER	707
MS 704 BELOW	1193
BENCH MS 704	1212
CC ASSOCIATION	1371

(2017-2018)

CONTINUATION OF PROJECT WOULD COMMENCE WITH RELOCATION OF THE WASH PLANT TO THE SOUTHEAST CORNER OF MS 703 ABOVE FROM ITS CURRENT LOCATION ON OK 707. THERE IS AN EXISTING SETTLING POND FROM WHOMEVER MINED THERE BEFORE SITUATED DIRECTLY NORTH AND ADJACENT TO THE NORTHERN BOUNDARY OF MS 707 OK CLAIM. I HAVE BUILT A BYPASS ROAD IN 2015-2016 ON THAT LINE, THAT BYPASS ROAD WILL ACT AS A DAM-DIKE TO HOLD BACK <sup>(SETTLING POND #1)</sup> SETTLINGS FROM NEW PLANT SITE. THE PREVIOUSLY MINED PIT FROM 2016 DIRECTLY SOUTH AND ADJACENT TO THE NORTH BOUNDARY OF MS 707 OK WILL BE USED AS SETTLING POND NO 2 FOR PROPOSED PROJECT. I WILL DO A DOZER CUT THROUGH THAT ROAD TO MOVE THE FIRST SECTION OF OVERBURDEN SOUTH INTO THE 2016 PIT TO SEAL THE PIT SO THAT IT HOLDS WATER AND TO FILL THE HOLE. THE PLAN IS TO MOVE THE FIRST SECTION OF OVERBURDEN 100' W X 150' L INTO THE 2016 HOLE, THEN REMOVE THE PAY DIRT, THEN MOVE THE NEXT SECTION OF OVERBURDEN INTO THAT HOLE THEN PROCEED UP THE HILL IN THAT MANNER. MOST ALL OF PAY DIRT IS UNDERNEATH OF THE EXISTING GLACIER CREEK ROAD. AS THIS WORK IS COMMENCING I WILL BUILD A BYPASS ROAD ALONGSIDE OF THE EAST BOUNDARY LINE OF MS 703 ABOVE CLAIM WHILE REMOVING PAY FROM UNDER THE CURRENT ROAD. WHEN THAT IS COMPLETED WE WILL REBUILD THE CURRENT ROAD, THEN REMOVE TEMPORARY BYPASS FROM THE EAST LINE OF MS 703 AND RELOCATE PLANT.

NEXT PAGE

EXCEPT SETTLING POND #2 AND #3. THIS PROJECT CONTINUING PROJECT.

RESPECTFULLY,



AFTER PLANT IS RELOCATED WE WILL SMOOTH AND LEVEL THE SOUTH TWO THIRDS OF CLAIM NOS BELOW ON COOPER GULCH. THIS AREA OF NOS BELOW, AS YOU CAN SEE FROM THE GOOGLE EARTH PICTURE IS A OLD CRUSHER SITE 100% DISTURBED GROUND. THE REASON FOR LEVELING IS TO CREATE A FLAT STURDY WORKING PAD FOR STORAGE OF ALL GRAVELS, WASHED SAND, ROCK, SPECIAL SIZED ROCK, AS THAT IS WHAT THE OWNERS OF THE GROUND, BEARING STRAITS NATIVE CORPORATION, WOULD LIKE TO DO. I WILL CONTINUE TO BOND THE CURRENT NINE ACRES FOR THE REMAINDER OF THIS YEAR AND ADD 5 ACRES FOR THE 2017-2018 MINING YEARS. ~~THE~~ AFTER THE WASH PLANT IS RELOCATED WE WILL HAVE ALL GROUND RECLAIMED EXCEPT SETTING POND #2 AND #3. THANK YOU FOR CONSIDERATION OF THIS ~~CONTINUING~~ CONTINUING PROJECT.

RESPECTFULLY,  
Steve Fomby



PLAN MAP OF OPERATION

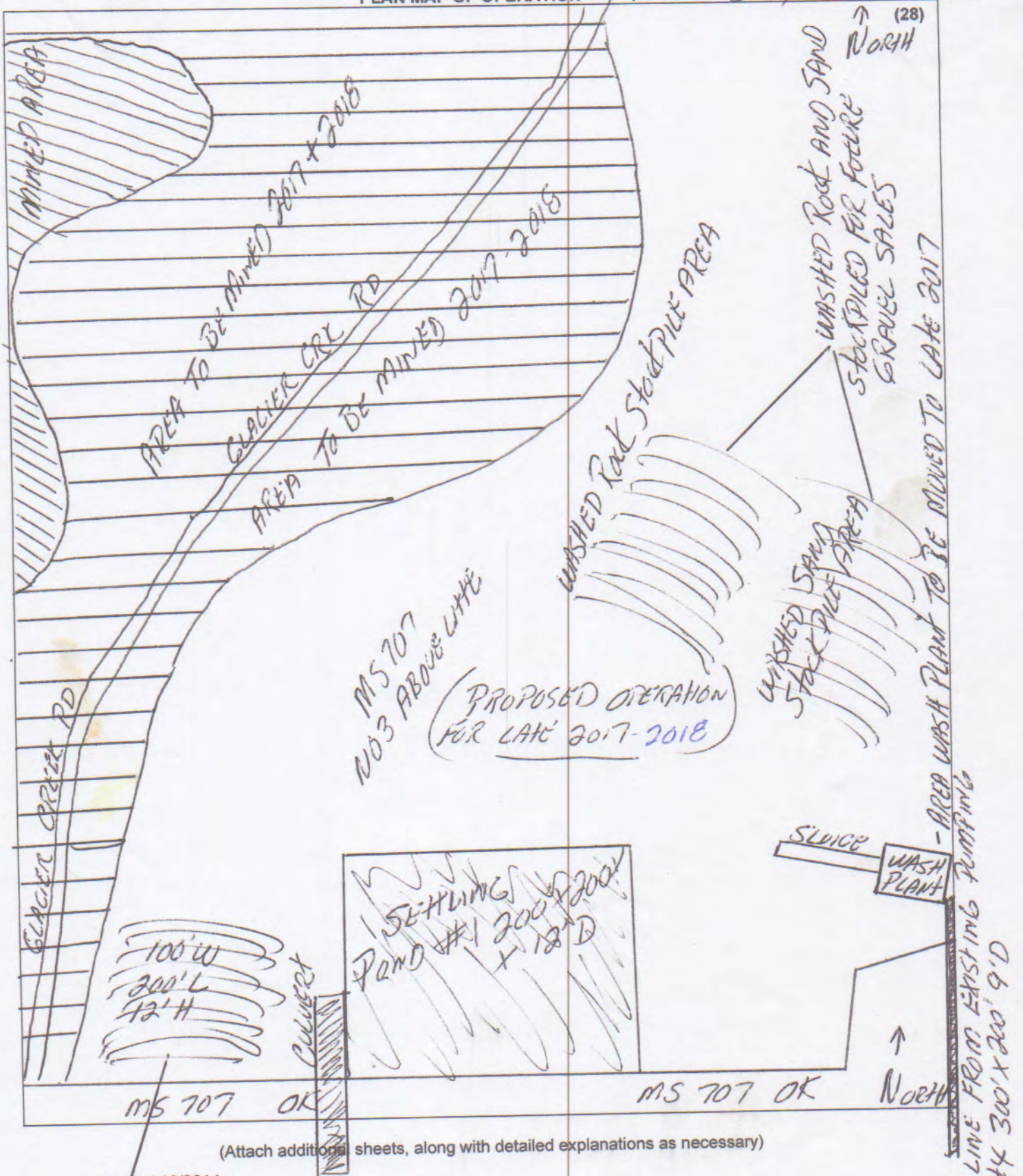

(Attach additional sheets, along with detailed explanations as necessary)

Revised 10/2014

TEMPORARY OVERBORDEN PILE TO START CUT WILL  
 BE SHOVED INTO SETTLING POND AREA #2 TO SEAL OFF.

WATER LINE FROM EXISTING PUMPING  
 POND #4 300' x 200' 9' D



SETTLING POND  
#2 150'x150'x9'D

(EXISTING)  
(OF 7-1-2017)

WATER  
WASH PLANT

SETTLING POND  
#3 300'x150'w 8'D

CULVERT TO  
PUMPING POND  
#4 300'x200'x9'

DAM, DIKE

SAND  
Stock PILE

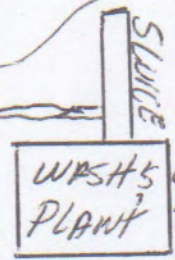

CURRENT POSITION  
TO BE MOVED IN  
2017-LATE.

LINE TO PLANT FROM  
PUMPING POND #1

~~WASHED ROCK  
Stock PILE~~

~~WASHER ROCK  
Stock PILE~~

WASHED SAND  
Stock PILE

GLACIER CREEK ROAD





Google Earth



MS 707 No.3 Little Creek 17.13 acres.  
AREA MINED IN 2014 + 2015

AREA TO BE MINED LATE 2017 + 2018

CLAIMS MAP



MOONLIGHT WILDS PROTECTION AREA BOUNDARY

North  
↑



2019 PLAN OF OPERATIONS UPDATE

CURRENT PHOTO